

Oyster vee

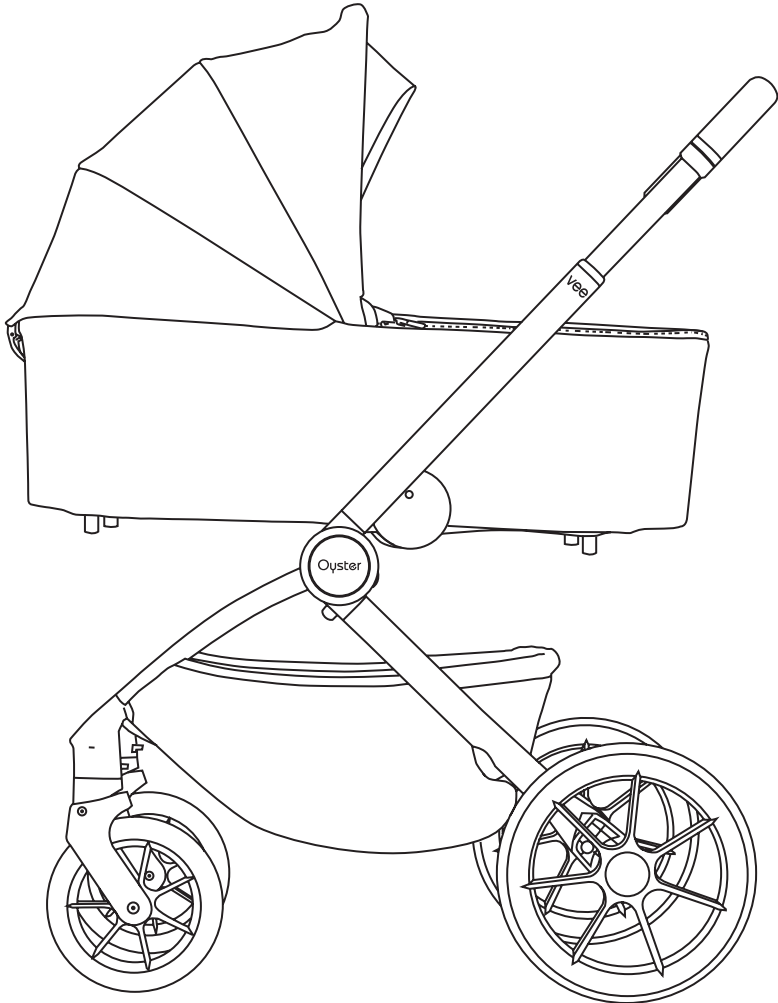

INSTRUCTION MANUAL



SCAN TO REGISTER
YOUR WARRANTY

CONTENTS

- 4 Important information and warnings
- 8 Stroller overview / What's in the box
- 10 Opening the chassis
- 11 Fitting and removing of front wheels
- 11 Fitting and removing of rear wheels
- 12 Folding the chassis with the seat unit fitted
- 15 Folding the empty chassis
- 15 Adjusting the handle height
- 16 Using the parking brake
- 16 Fitting and removing the bumper bar
- 17 Fitting and removing the seat unit
- 18 Reclining the seat unit
- 19 Adjusting the calf rest
- 19 Using the hood/sun canopy
- 19 Extending the hood
- 20 Seat unit ventilation
- 20 Using the sun visor
- 20 UPF indicator
- 21 Using the 5-point harness
- 23 Fitting the stroller rain cover
- 23 Fitting the carrycot rain cover
- 23 Fitting the footmuff
- 24 Assembling the carrycot
- 25 Fitting the carrycot apron
- 26 Adjusting the carrycot hood
- 26 Using the sun shade
- 27 Carrycot ventilation
- 27 Using the carrycot sun visor
- 28 Fitting the carrycot to the chassis
- 28 Removing the carrycot
- 29 Folding Oyster Vee with the carrycot attached
- 30 Unfolding Oyster Vee with the carrycot attached
- 32 Attaching/removing the height adaptors
- 34 Fitting the Oyster car seat to the chassis
- 35 Removing the Oyster car seat from the chassis
- 36 Care and maintenance
- 37 Warranty Policy
- 38 Warranty Terms

IMPORTANT - READ CAREFULLY AND KEEP FOR FUTURE REFERENCE.

Important Safety Information

- Single seat mode: This mode (single seat) is suitable for children from newborn to 4 years or up to a maximum weight of 22kg, whichever comes first. With a car seat attached birth to 13kg, with a carrycot attached birth to 9kg.
- The seat unit, carrycot or car seat is suitable for one child only to the maximum weight stated above.
- It is important that any person intending to use this stroller understands the instructions.

 **WARNING:**

- Never leave the child unattended.
- Ensure that all locking devices are engaged before use.
- To avoid injury ensure that your child is kept away when unfolding and folding this product.
- Do not let the child play with this product.
- Always use the restraint system (safety harness).
- Always use the crotch strap in combination with the waist belt.
- Always check that the pram body/carrycot or seat unit or car seat attachment devices are correctly engaged before use.
- Check the chassis correctly engaged before use.

 **WARNING:**

- This product is not suitable for running or skating.
- The maximum weight for the shopping basket is 5kg.
- Never lift/carry the chassis while occupied. Your child's safety may be at risk.
- Do not use the vehicle on steps, stairs or escalators; as it may be dangerous to your child.
- Always descend/mount kerbs on the back wheels; do not tip the stroller forward.
- The parking device should be engaged when placing and removing children.
- Any load attached to the handle and/or on the back of the backrest and/or on the sides of the vehicle will affect the stability of the vehicle
- Always use the seat in the most reclined position for new born babies to approx. 6 months.
- Never leave the stroller without first engaging the parking device. Avoid uphill or downhill parking.
- Pram body/carrycot: This product is suitable for a child who cannot sit up unaided, roll over and cannot push itself up on its hands and knees. Maximum weight of the child 9kg.
- Incorrect assembly, folding or use of this vehicle may cause damage and affect the safety of the stroller.

WARNING:

- Do not add another mattress on top of the mattress provided or recommended by the manufacturer.
- This vehicle does not replace a cot or a bed. Should your child need to sleep then it should be placed in a pram body, or a cot or bed.
- Do not leave anything in the carrycot that could present a danger of suffocation e.g. non-rigid toys, pillows etc.
- Do not place the carrycot close to another product which could present a danger of strangulation e.g. strings, blinds/curtain cords etc.
- Do not use accessories that are not approved by the manufacturer.
- Do not use replacement parts other than those supplied by the manufacturer or supplier.
- Overheating can endanger the life of the child! Take into account the ambient temperature and the child's clothing and ensure that the child is not too hot or too cold.
- It is recommended you ask a health professional for advice on safe sleeping.
- It is recommended that the carrycot canopy is folded back and the apron - top cover - is removed when the child is sleeping in the carrycot indoors.
- If any cup holder is used in conjunction with this vehicle, **DO NOT USE HOT LIQUIDS.**

WARNING:

- Never use this product on a stand.
- Always fold the sun visor/peak in when folding the product to avoid marks or damage.
- When moving the carrycot, be aware of the hazards of bumping onto the floor / into door frames etc, the child in the carrycot could be injured.

Oyster Vee is compatible with the Oyster Vee Carrycot, and Oyster Car Seat (with multi car seat adaptors).

Only use compatible seat units, pram bodies/carrycots as stated by the manufacturer, otherwise you may be putting the child at risk.

Please check babystyle.co.uk for infant car seat compatibility with other brands.

Manufactured and tested in compliance with EN1888-1:2018+A1:2022, EN1888-2:2018+A1:2022 and EN1466:2023.

Oyster
vee

STROLLER OVERVIEW

What's in the box

- Chassis with seat unit and basket
- Folded carrycot
- Manual
- Bumper bar
- 2x front wheels and 2x rear wheels
- Backpack
- Footmuff
- Stroller Apron
- Carrycot mattress
- Multi car seat adaptors
- Bottle holder
- Height increasers
- Stroller and carrycot raincovers

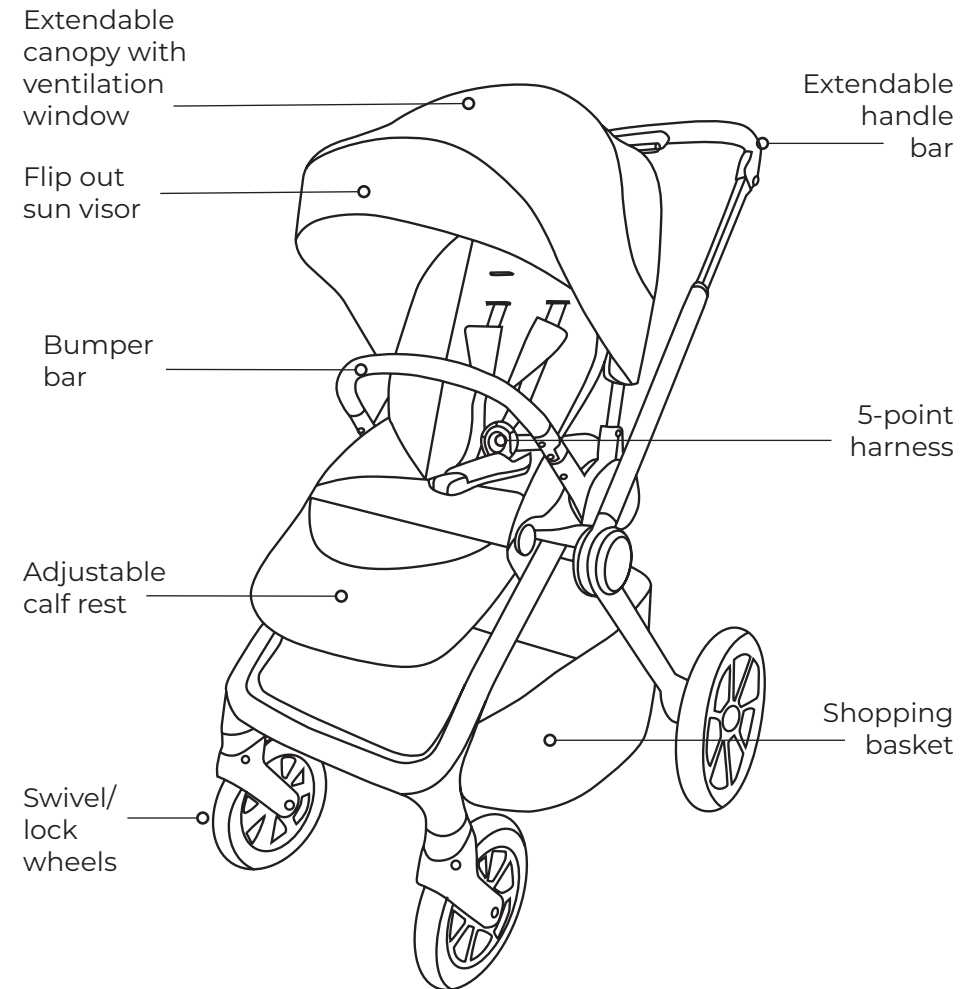

For a full list of features, head to babystyle.co.uk.

The illustrations in this manual are used to demonstrate the operation of the product. Where there are small differences between the physical object and the illustrations, the physical stroller shall prevail.

OPENING THE CHASSIS

WARNING: To avoid injury ensure that children are kept away when unfolding and folding this product.

1a. Lift the chassis upright with the small carrying handle at the top.

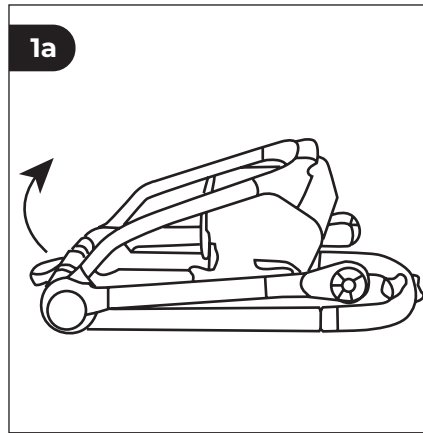

1b. Pull the front and back sections of the chassis outwards.

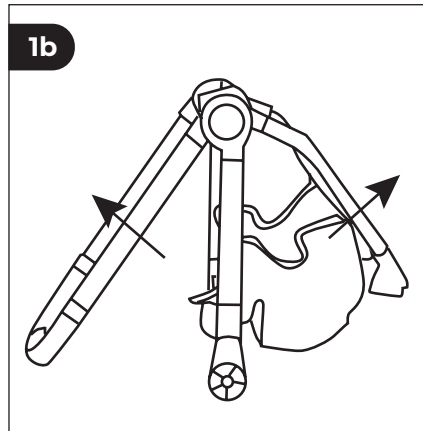

1c. Continue to pull the adjustable handle upwards until you hear a click, your chassis is now unfolded and secure.

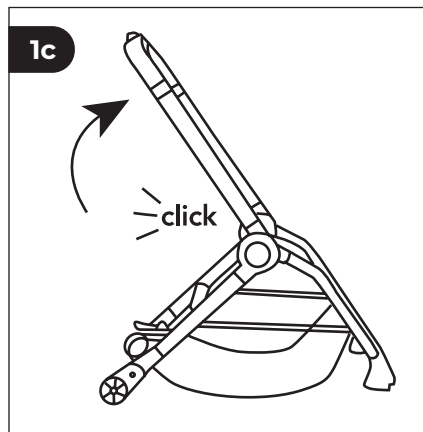

FITTING AND REMOVING OF FRONT WHEELS

2. Push the front wheel axle stub into the front wheel housing until it clicks into position.

The front wheels can be locked in position, using the switch behind the unit.

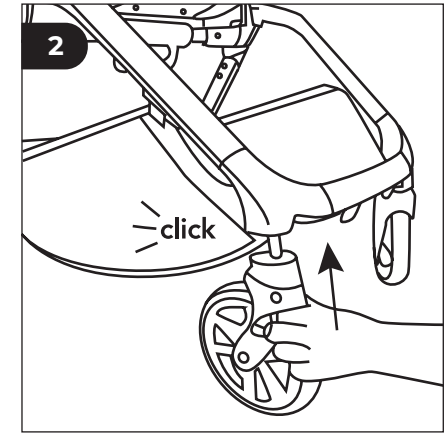

3. To remove the wheel; with a flat head screwdriver, push-in the release button on the chassis; the wheel can now be disconnected from the chassis.

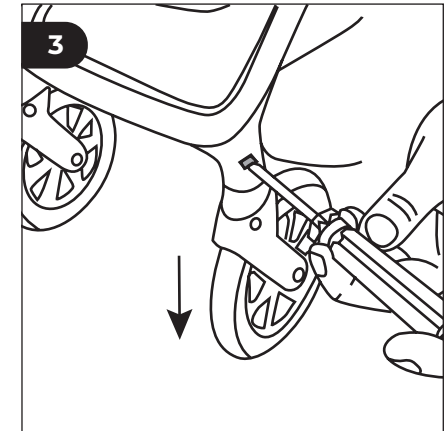

FITTING REAR WHEELS

4. Push the axle stub on the wheel into the rear wheel housing. The wheel should lock in position with a click.

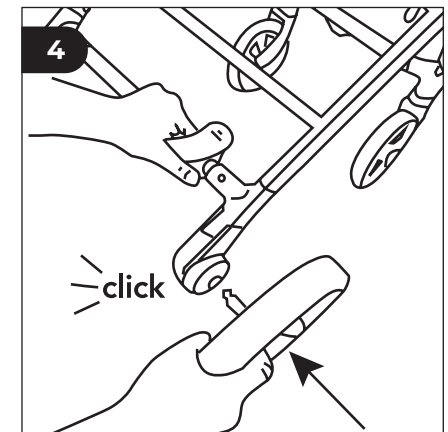

REMOVING REAR WHEELS

5. To remove the rear wheels; press and hold the button on the wheel housing behind the rear wheel, the wheel can now be disconnected from the chassis.

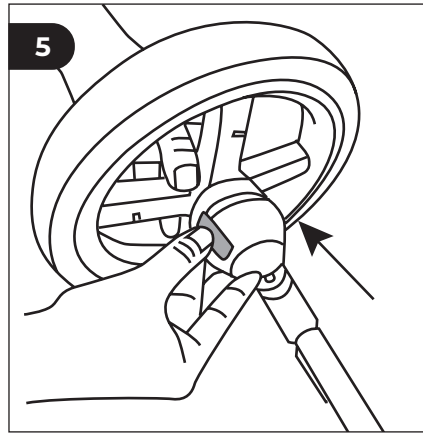

FOLDING THE CHASSIS WITH THE SEAT UNIT FITTED

NOTE: Before folding, tuck away the sun visor/peak on the canopy.

WARNING: Ensure the child is well clear of moving parts and all items are removed from the shopping basket.

The stroller will fold with the seat unit both forward facing & parent facing.



6a. To fold the chassis with the seat unit parent facing: first apply the brake, then whilst pulling the seat recline lever, bring both the upper seat back and the footrest together, so that they meet parallel to the adjustable handle 6b.

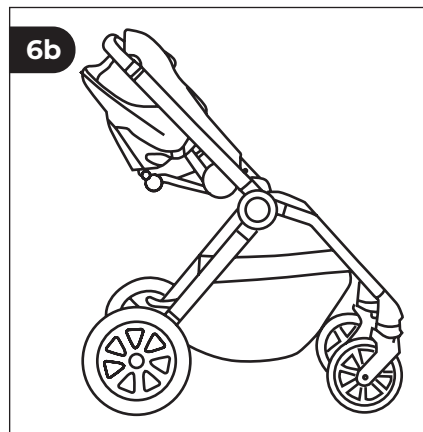

6c. Hold the button down on the handle and then rotate the handle so it's facing upwards. Then lift the handle upwards for the chassis and seat unit to fold into themselves and achieve the folded position.

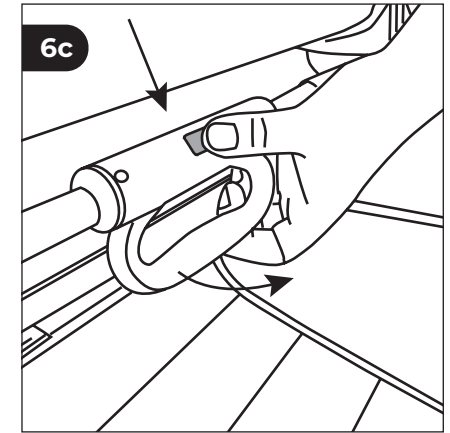

6d. The folded stroller can now be carried easily using the small carrying handle.

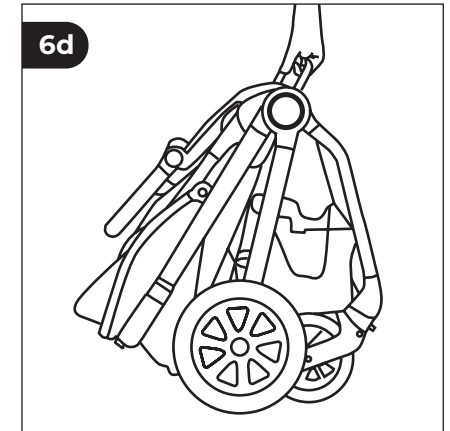

7a. To fold the chassis with the seat unit forward facing: first apply the brake, then pull the foot rest upwards to meet the seat, so that they meet parallel to the adjustable handle 7b.

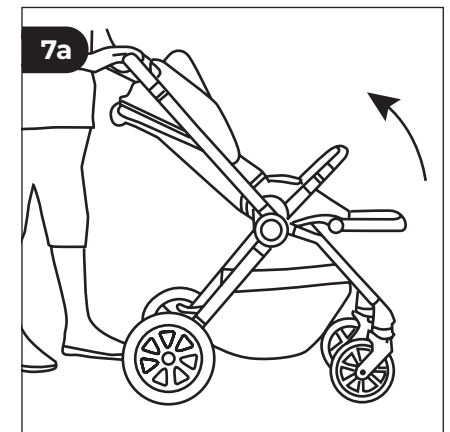

7b. With the seat unit lifted to the higher position and aligned with the chassis, the stroller can now be folded.

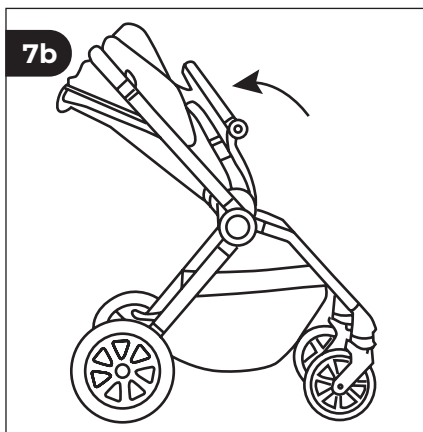

7c. Hold the button down on the handle and then rotate the handle so it's facing upwards. Then lift the handle upwards for the chassis and seat unit to fold into themselves and achieve the folded position.

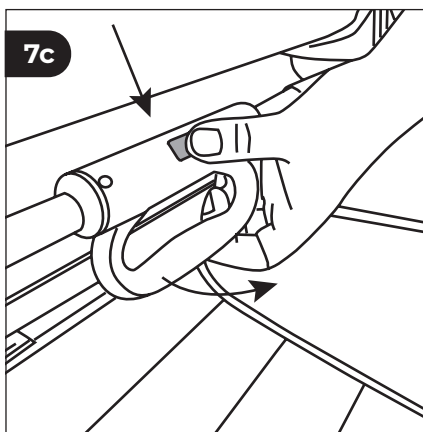

7d. The folded stroller can now be carried easily using the small carrying handle.

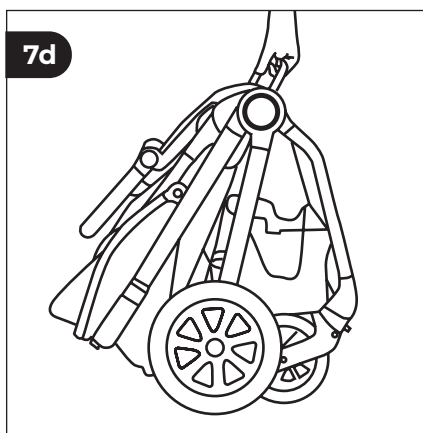

FOLDING THE EMPTY CHASSIS

8a. Hold the button down on the handle and then rotate the handle so it's facing upwards. Then lift the handle upwards for the chassis and seat unit to fold into themselves and achieve the folded position.

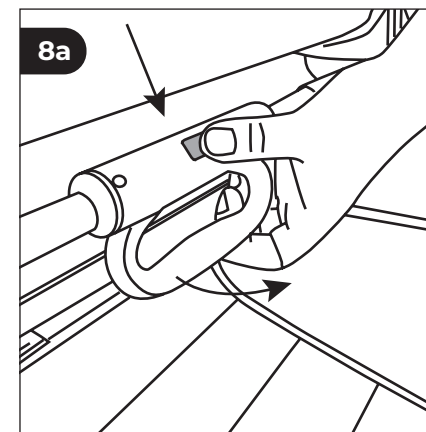

8b. The folded stroller can now be carried easily using the small carrying handle.

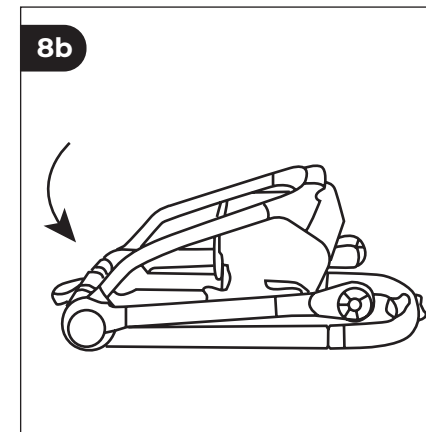

ADJUSTING THE HANDLE HEIGHT

9. The handle height is adjustable to four positions. To adjust the handle height, hold in the button in the middle of the handle grip, slide the handle up or down to one of the four positions. The handle will click into one of the pre-set positions when the button is released.

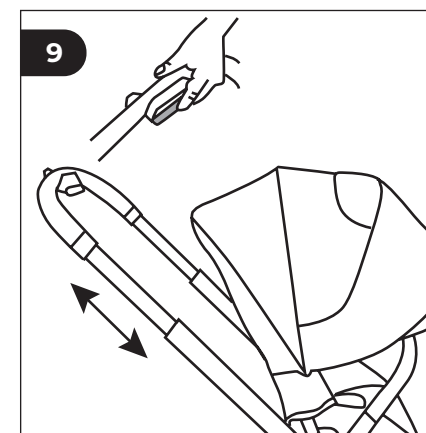

USING THE PARKING BRAKE

15. To engage the brake, firmly press down on the brake lever found on the rear axle. Check that the brake is fully engaged before letting go of the handle.

WARNING: Never leave the stroller without first engaging the brake.

WARNING: Always ensure that the parking brake is applied when placing and removing children.

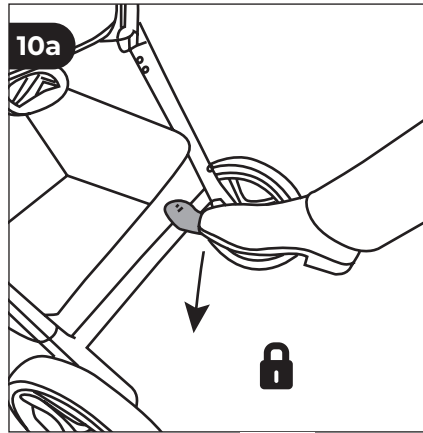

10b. To release the brake, press forwards or lift up the brake lever with your foot until the wheel moves freely.

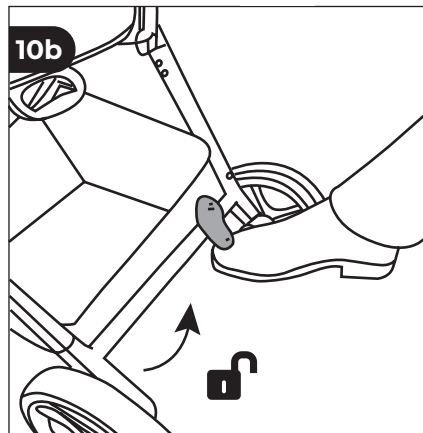

FITTING AND REMOVING THE BUMPER BAR

11a. Push both ends of the bumper bar into the corresponding entry slots on the seat unit until the bumper bar locks into position.

WARNING: Keep children clear when attaching and removing the bumper bar.

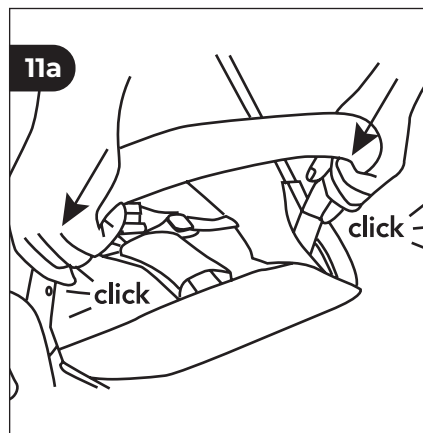

11b. To remove the bumper bar, press in the bumper bar release buttons on either side underneath the entry slots on the seat unit.

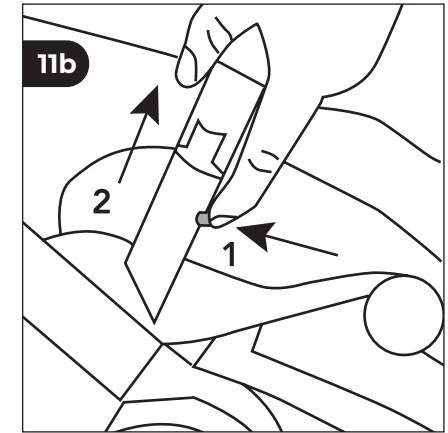

FITTING AND REMOVING THE SEAT UNIT

12a. To remove the seat unit, use the memory buttons on each side on top of the hubs. Click one button, then click the other-sided button, and lift 12b.

Once the buttons have been clicked down, the seat unit must be lifted away from the chassis (this resets the buttons) before it can be reattached.

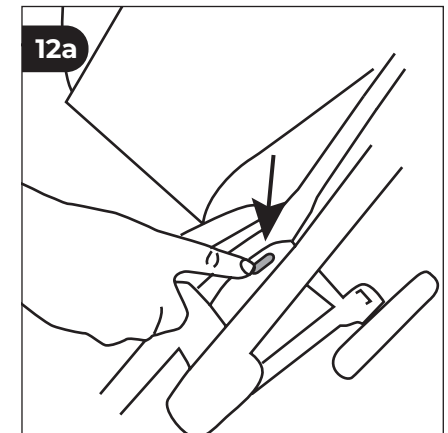

To attach the seat unit, do the reverse by aligning the seat attachments into the central hubs on either side of the chassis. Push down until the seat unit clicks and locks into position. Ensure the seat unit is locked in position by trying to pull the seat from the chassis. The seat unit can be fitted facing forwards or rearwards.

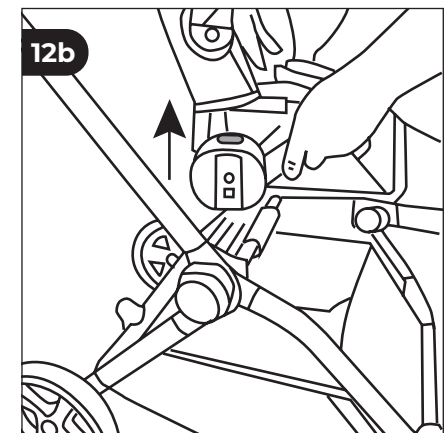

RECLINING THE SEAT UNIT

13a. Lift the lever at the top rear of the back-rest to change the recline position. Lift the lever again to select a different recline position.

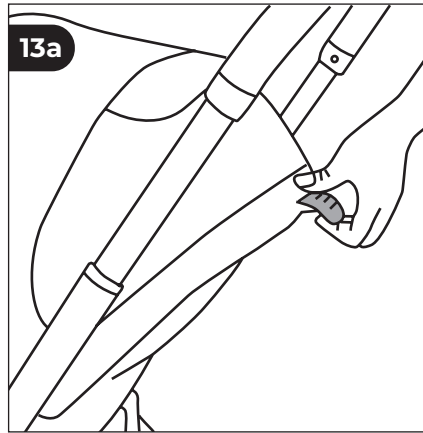

13b. The seat unit can be set to 3 positions, Upright, Reclined and Lie-flat 13c.

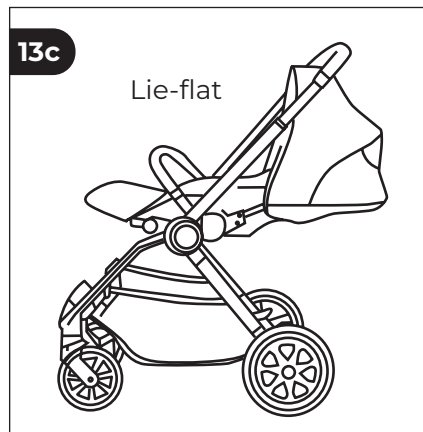
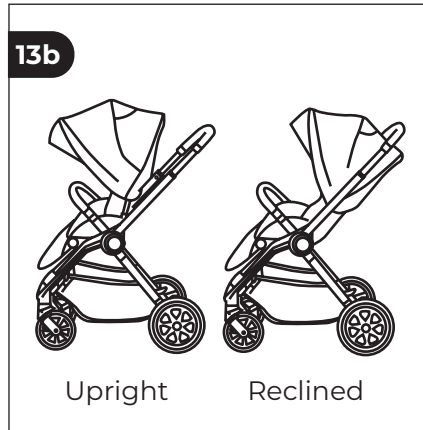

ADJUSTING THE CALF-REST

14. To lower the calf-rest hold in the buttons on both sides and push down on the calf-rest.

To raise the calf-rest into higher positions, lift the calf-rest and it will automatically click into the next position.

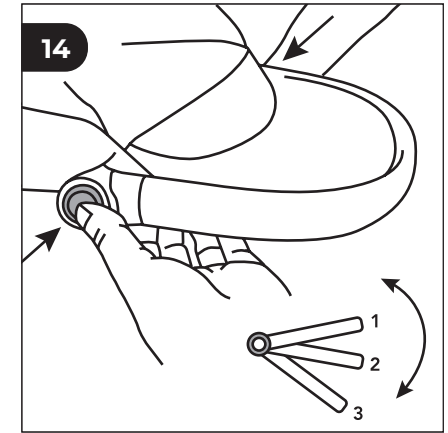

EXTENDING THE CANOPY

15a. To extend the canopy, undo the zip across the back of the hood.

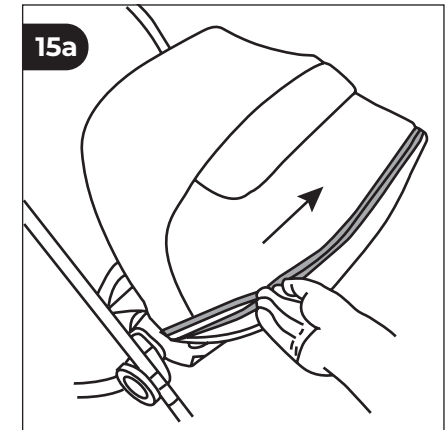

15b. Push the canopy forward to gain the full extension. Do the reverse of the instructions to put the canopy position back to before.

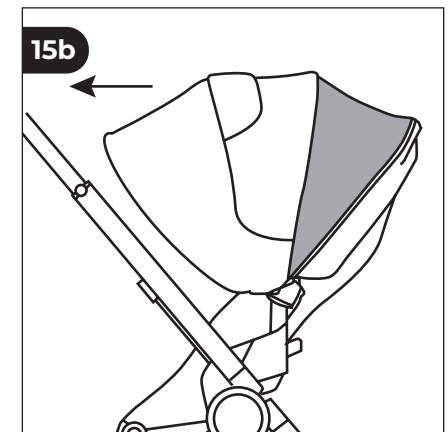

SEAT UNIT VENTILATION

16. To utilise the peekaboo ventilation window fold the fabric flap towards the front of the hood.

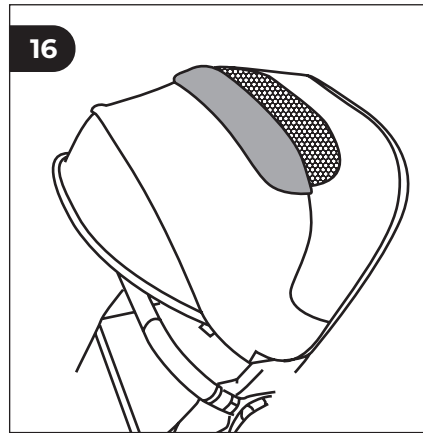

USING THE SUN VISOR

17. The sun visor is neatly folded inside the front of the hood. Simply reach in and pull the visor and it will spring forward into position.

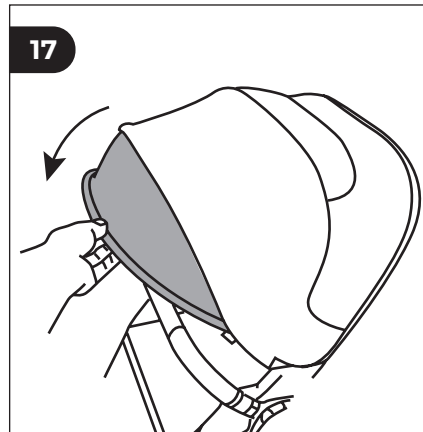

UPF INDICATOR

18. The sun canopy features a reactive tag which is an indicator of UV levels. The more vibrant the colour, the higher the UV levels directly on the canopy.

WARNING: The UPF Indicator is to demonstrate UV levels and is not scientifically proven. Please keep your baby out of direct sunlight.

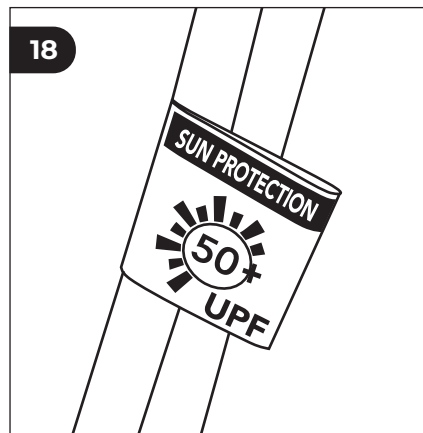

USING THE 5-POINT HARNESS

19a. Always apply the parking brake before placing your child in the vehicle.

The restraint system (safety harness) has two shoulder straps, a waist belt, crotch strap and magnetic buckle 19b.

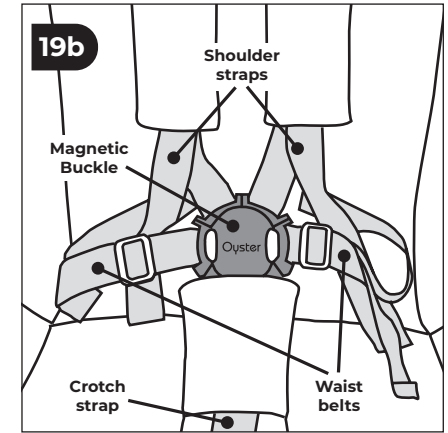

19c. Place the two shoulder straps over baby's shoulders and the waist belt around the waist. The crotch strap should be placed between the child's legs.

To secure, fit together the left connector from the shoulder strap with the left connector from the waist belt, and the same for the other side.

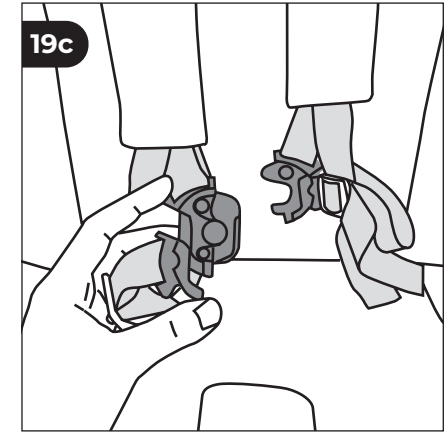

19d. Join the sides together using the magnets until you hear a click.

Place the buckle from the crotch strap on top until you hear a click. The buckle is now secure.

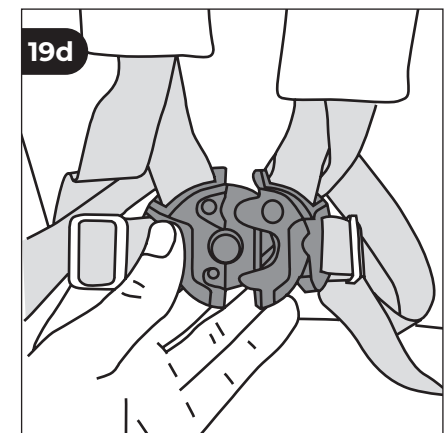

19e. To release the 5-point magnetic buckle, firmly press the buttons either side and pull the front part away. Then do the reverse as the previous instructions.

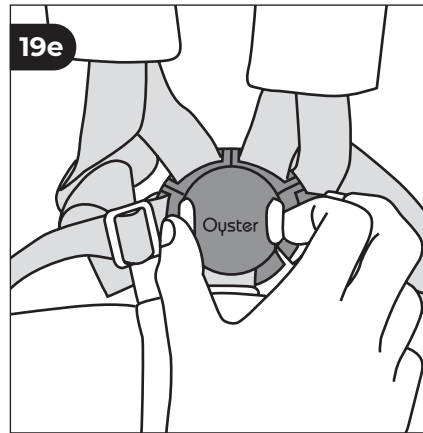

19f. The harness can be adjusted to suit your child by sliding the adjusters along the shoulder straps and waist belt.

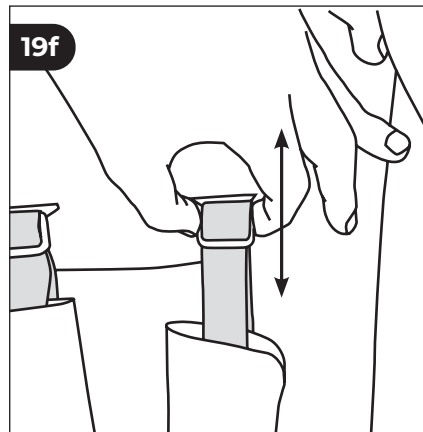

The crotch strap can be adjusted to suit your child. There are two button holes in the seat base. Thread the buckle through the hole in the plastic seat base then through the opening in the seat covers and reposition, passing back through first the seat cover and then through the opening in the plastic seat base.

WARNING: Ensure the buckle and connectors are fully engaged before use.

WARNING: Always use the crotch strap in combination with the waist belt.

ALWAYS USE THE SAFETY HARNESS

FITTING THE STROLLER RAIN COVER

20. To fit the stroller rain cover the hood needs to be fully extended. Unfold and place the rain cover so that it covers all the textile parts. Pull the elasticated bottom of the rain cover over the leg support.

FITTING THE CARRYCOT RAIN COVER

21. To fit the carrycot rain cover the hood needs to be fully extended. Unfold and place the rain cover so that it covers all the textile parts. Pull the elasticated bottom of the rain cover over the leg support.

FITTING THE FOOTMUFF

22. The footmuff boot cover can be removed by unfastening the zip. The base of the footmuff can be used as seat liner without the boot cover. To attach the footmuff to the seat unit; release the harness clips from the centre buckle and release the shoulder straps from the waist belts at the buckle connection. Pass the shoulder straps and waist belts through the corresponding openings in the footmuff. Zip up the boot cover and finally place the flap over the bumper bar, and fasten with the central magnet hidden in the middle.

ASSEMBLING THE CARRYCOT

WARNING: This product is only suitable for a child who cannot sit up unaided. Max. 9kg.

WARNING: Only use on a firm, horizontal level and dry surface.

23a. The carrycot folded.

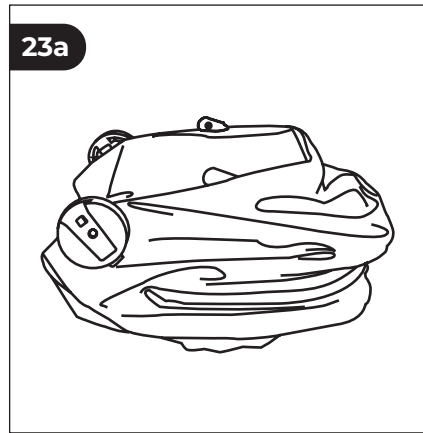

23b. To unfold the carrycot, grip both ends and push apart until you hear a click.

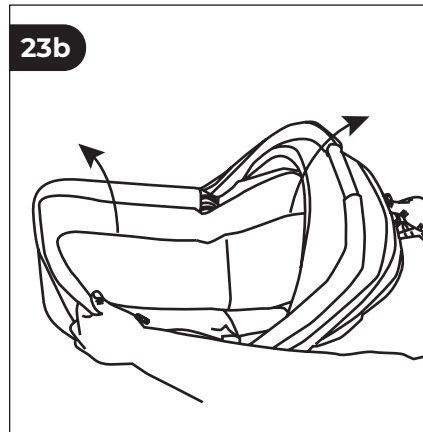

23c. Once the carrycot is open and secure, place the mattress into the base.

WARNING: When storing the carrycot for long periods, remove the mattress and store separately.

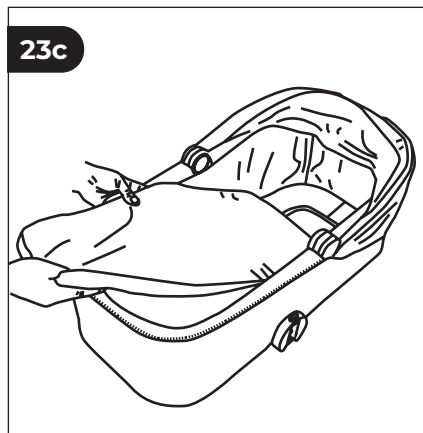

23d. Pull up on the canopy handle until you hear a click, the carrycot is now open and secure.

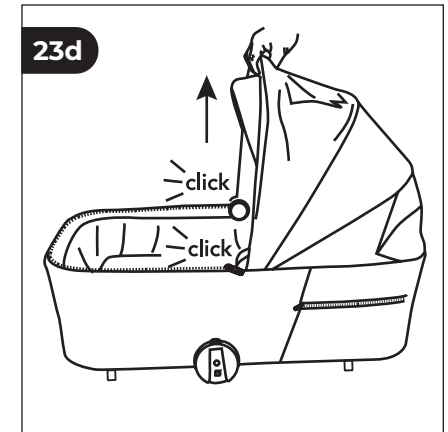

FITTING THE CARRYCOT APRON

24a. Fasten the zip on the apron to the corresponding zip on the carrycot and pull all the way around.

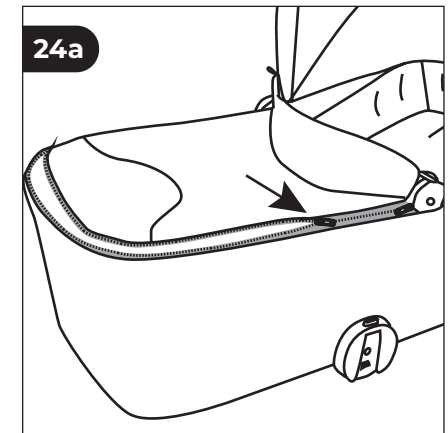

WARNING: The carrycot can not be fitted forward facing.

WARNING: Do not use if any part of the carrycot is broken, torn or missing.

WARNING: Do not add another mattress on top of the mattress provided or recommended by the manufacturer.

WARNING: Do not place the carrycot near an open fire or other source of strong heat.

WARNING: Do not let children play unattended near the carrycot.

WARNING: The handles and the bottom of the carrycot should be inspected regularly for signs of damage and wear.

WARNING: Before carrying or lifting, ensure the handle is in the correct locked position.

WARNING: The head of the child in the carrycot should never be lower than the body of the child.

ADJUSTING THE CARRYCOT HOOD

26. Press in the buttons on the insides of the hood and pull up until you hear them click into place. Press in the buttons again to put the hood down.

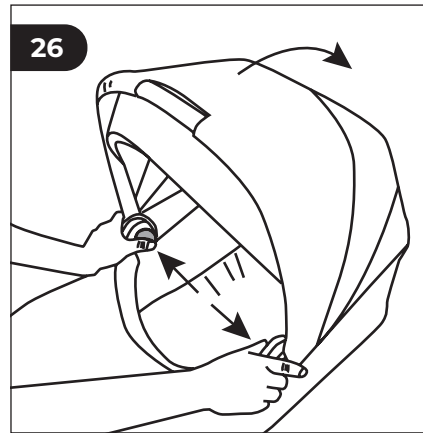

USING THE SUN SHADE

27a. Inside the lining of the hood you will find the sun shade.

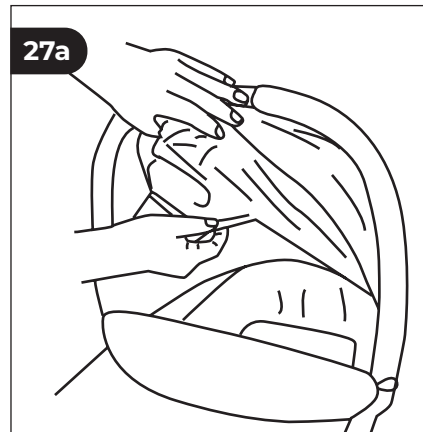

27b. Pull the sun shade fully out, stretch over the front of the carrycot body.

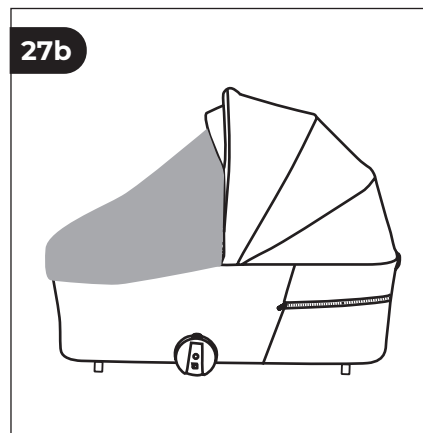

CARRYCOT VENTILATION

28a. Unzip the carrycot ventilation flap.

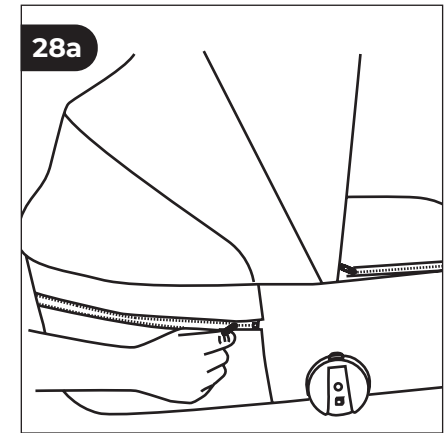

28b. Fold the flap downwards

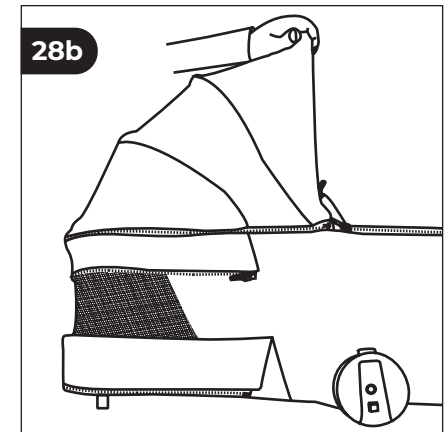

USING THE SUN VISOR

29. The sun visor is neatly folded inside the front of the carrycot hood. Simply reach in and pull the visor and it will spring forward into position. The visor is attached by a zip if you wish to remove or reattach.

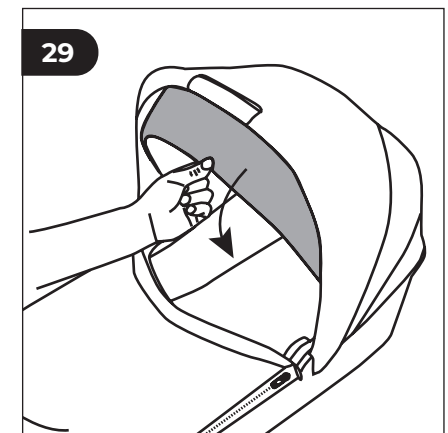

FITTING THE CARRYCOT TO THE CHASSIS

30. The carrycot can only be fitted to the chassis when the seat unit has been removed. The carrycot can only be fitted to the chassis parent facing. Lower the carrycot into the attachment slots on the left and right. Push down until the carrycot clicks and locks into position. Check the carrycot is securely attached by trying to lift the carrycot from the chassis.



REMOVING THE CARRYCOT

31a. To remove the carrycot, the memory buttons on each side on top of the hubs need to be pressed down until you hear a click.

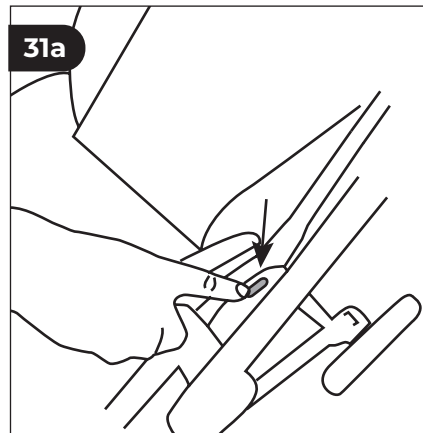

The process is; to click one button, then click the button on the other side, and then lift 31b.

Once the memory buttons have been clicked down, the carrycot must be lifted away from the chassis (this re-sets the buttons) before it can be reattached.



FOLDING OYSTER VEE WITH THE CARRYCOT ATTACHED

32a. To fold the chassis with the carrycot attached: first apply the brake then tuck away the sun visor.

Pull the lever at the back of the carrycot, then push both sides into each other so that they meet parallel with the chassis and adjustable handle. 32b.



WARNING: When folding, please tuck in the sun visor/peak on the carrycot canopy to avoid any damage, marks, or creases on the carrycot apron.



32c. Hold the button down on the carry handle and then rotate the handle so it's facing upwards. Then whilst holding the handle, lift upwards for the chassis and carrycot to fold into themselves and achieve the folded position.

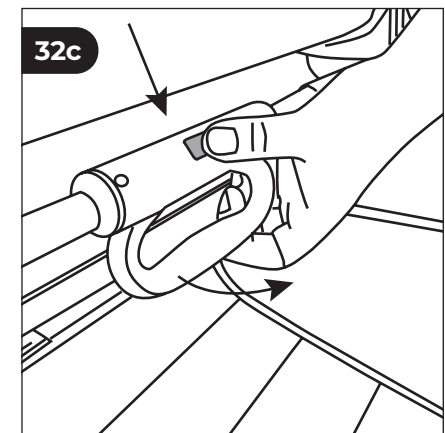

32d. The folded chassis with carrycot can now be easily carried using the small carrying handle.

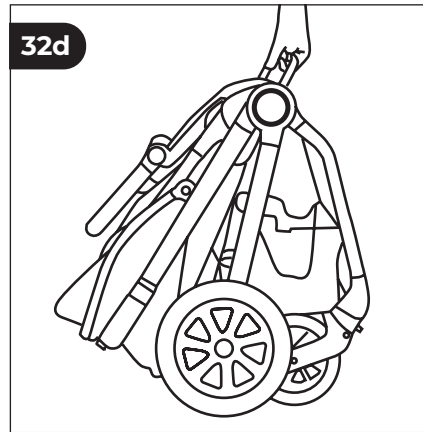

UNFOLDING OYSTER VEE WITH THE CARRYCOT ATTACHED

33a. Unfold the Oyster Vee in its freestanding position by placing one hand on the handlebar, and one on the chassis just above the front wheels.

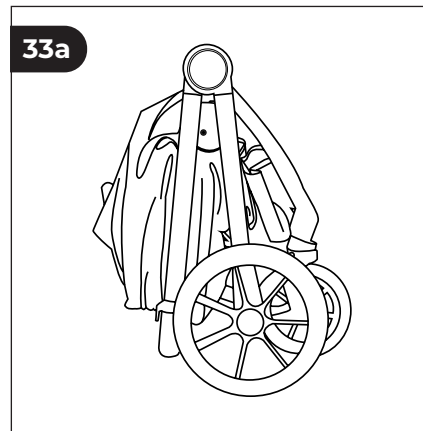

33b. Whilst stabilising the chassis to the floor with one hand, pull the handlebar upwards and bring the chassis into its standing position.

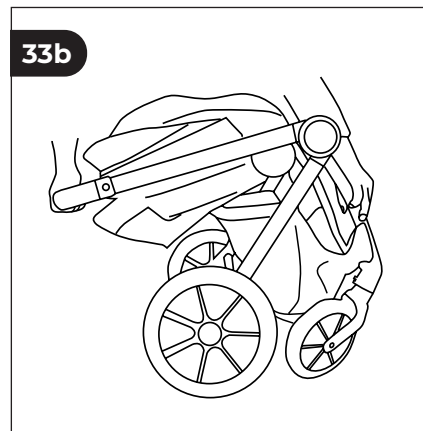

33c. Once the chassis is stood up and locked in, unfold the carrycot on the chassis by bringing the canopy away from the apron section.

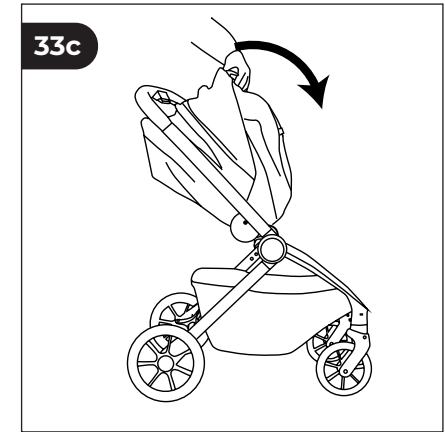

33d. When the base of the carrycot is flat, ensure it is properly locked in by pushing down both ends and hearing an audible click. Then pull the canopy up using the handle until it is clicked in.

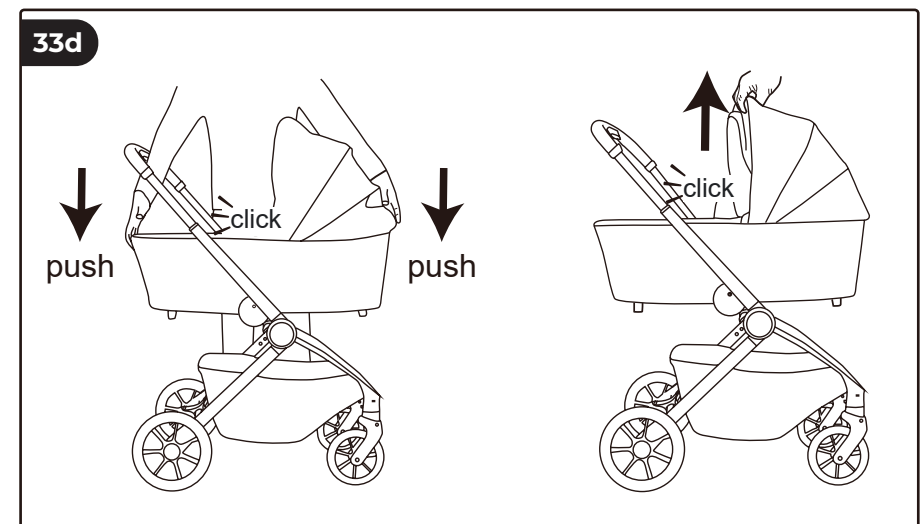

ATTACHING THE HEIGHT ADAPTORS

34a. Place the adaptor into the slot on the chassis, using the corresponding 'L' and 'R' on the adaptors.

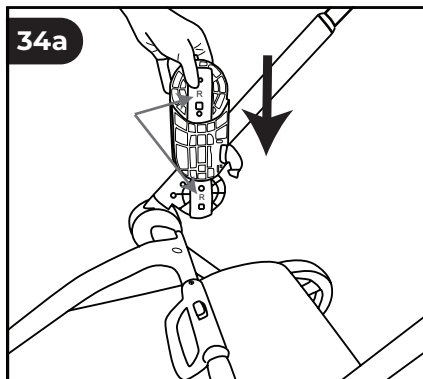

34b. Once placed onto the chassis, close the latch on the adaptor to secure.

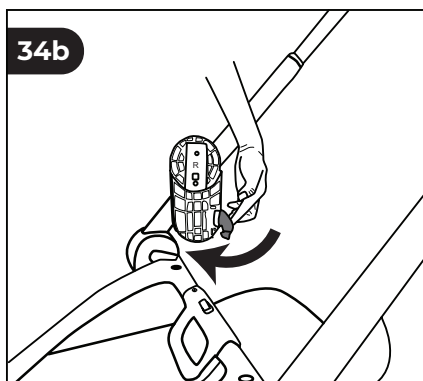

34c. Do this for both sides before attaching carrycot/seat unit.

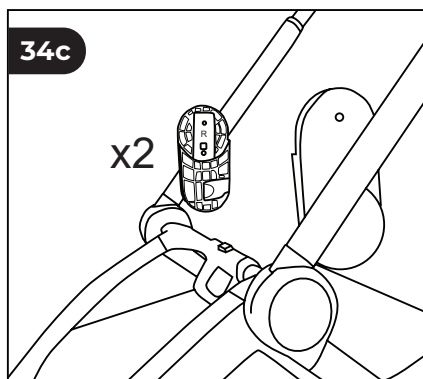

34d. Attach the carrycot/seat unit onto the adaptors, for a higher setting.

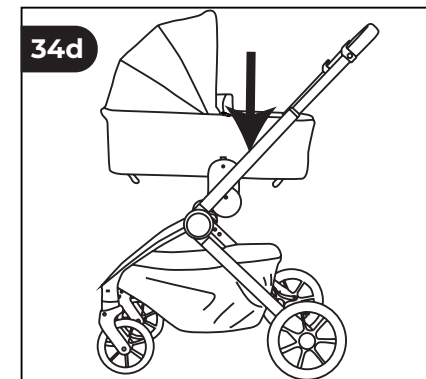

35a. TO REMOVE: Press the memory buttons on both sides of the carrycot/seat unit, then lift off of the adaptor.

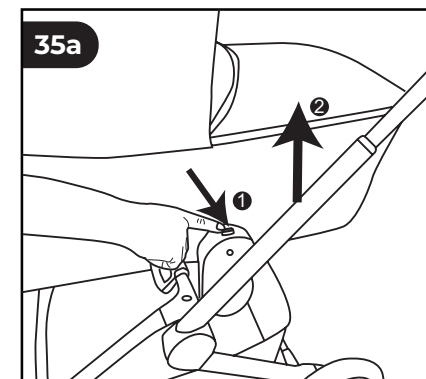

35b. Remove the adaptor by detaching the latch, and lifting the adaptor from the chassis.

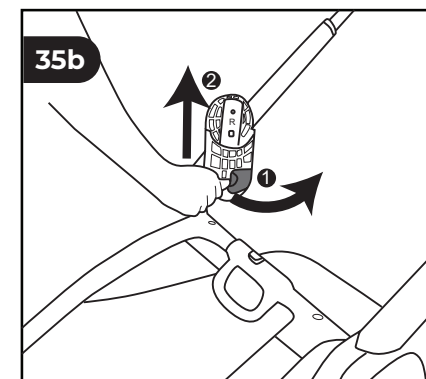

FITTING THE OYSTER CAPSULE CAR SEAT TO THE CHASSIS

36. The car seat can not be attached to the chassis until the seat unit or carrycot has been removed. The multi adaptors fit many leading brands of car seats (check with your retailer for full details). Insert the car seat adaptors into the chassis attachment devices. The adaptors and chassis attachment devices are marked with an 'L' and 'R' to represent left and right from the perspective of you being in the pushing position.

36. Hold the car seat by the carry handle and lower the car seat onto the multi adaptors. The adaptors should slot into the cavity at the base of the car seat handle left and right. Push down the car seat firmly until the car seat clicks and locks into position. Check that the car seat is secure and locked by pulling up on the car seat handle.

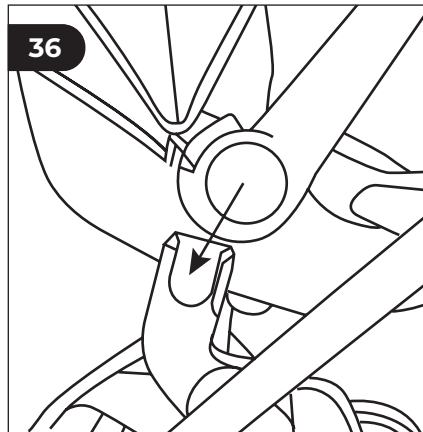
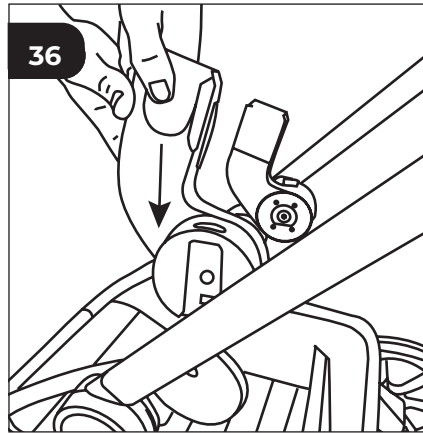

REMOVING THE OYSTER CAR SEAT FROM THE CHASSIS

37. To remove the car seat from the chassis: Press down on the two buttons on the sides of the car seat and lift the car seat away from the chassis.

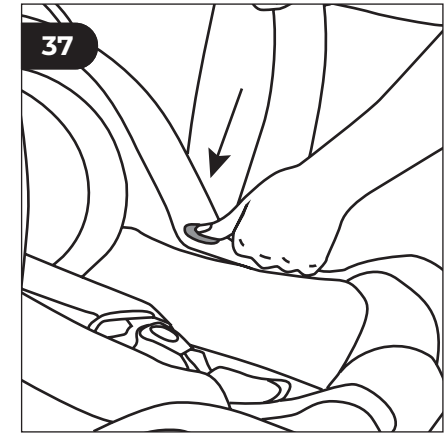

38. To remove the adaptors from the chassis push in the buttons on the bottom of the adaptors and lift the adaptors away from the attachment device.

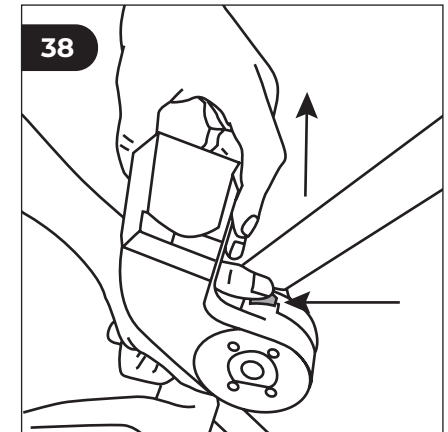

WARNING: Should your child need to sleep, then they should be placed in a suitable pram body, cot or bed.

Children should be clear of moving parts while making adjustments.

CARE AND MAINTENANCE

- Regularly check screws, rivets, bolts and fastenings to ensure they are locked tight and secure. Replace any parts in an inferior condition. When using this product during the winter, by the sea or off road it is important to clean using fresh water and dry thoroughly. Salt water and salt and grit from the roads will corrode metal parts unless removed.
- Check on a regular basis that all chassis locking devices are working correctly.
- If any part of the product is damaged, contact your local BabyStyle retailer immediately without using the pushchair.
- Do not expose the product to excessive sunlight, even normal exposure to sunlight may cause change to the colour of the fabrics.
- Take care not to tear fabrics when transporting the stroller.
- Light oil or petroleum jelly (vaseline) can be used to lubricate moving parts. Periodically remove the rear wheels; clean, lubricate and replace.
- Ensure all zips are either fully open or closed to prevent damage.
- Always use the rain cover in inclement weather.
- Do not place items on top of the hood/canopy, it could damage the fabrics or render the product unsafe.
- Any load attached to the handle and/or on the back of the back rest and/or on the sides of the stroller will affect the stability of the stroller.
- Tyres can leave marks on some surfaces such as vinyl flooring or carpet.
- Fabrics should only be cleaned in accordance to the care labels.
- Do not place fabrics in a washing machine, hand wash or sponge clean only using mild detergent and warm water (30°C).

WARRANTY POLICY

KEEP YOUR ORIGINAL RECEIPT OF PURCHASE SAFE WITH YOUR WARRANTY INFORMATION

It will be required should you unfortunately find a defect. The receipt must show the date of purchase clearly. In the first instance you must contact the original place of purchase. Repairs to any part of this product do not extend the warranty period. Do not return your product direct to the manufacturer.

SERVICING OF YOUR OYSTER VEE STROLLER

We recommend that this product is regularly maintained and is serviced by a BabyStyle authorised dealer at least every 12 months. Only replacement parts supplied or recommended by the manufacturer/ distributor shall be used.

DISCLAIMER

Whilst we believe the information set out in this instruction manual to be correct and reliable at the time of print, we do not accept responsibility for its accuracy and we shall not be liable for its interpretation and its use. We reserve the right to change, modify, add or delete product specifications at any time without prior notice.

YOUR WARRANTY POLICY

At BabyStyle, we guarantee your product has been manufactured in accordance with all current European safety standards which are applicable to this product, and that this product is free from any defects in workmanship and material at the time of purchase. During the production process this product has gone through rigorous quality checks. Despite our efforts, if this product does show a manufacturing or material defect within the 24 months warranty period for the chassis and seat frames and 6 months seat fabrics and PVC rain cover, we will comply to the warranty terms and conditions providing the product has been used for normal use as described within the instruction manual and it has been serviced and maintained correctly as described in the instruction manual. For further information please contact the place of purchase. Please retain your original receipt of purchase safely.

WARRANTY TERMS

Chassis: 24 consecutive months.

Fabrics, accessories and PVC rain cover: 6 consecutive months.

The warranty only applies to the original purchaser and is non-transferable.

The warranty will be invalidated in the following circumstances:

- The product has not been used for its intended purpose as described within the instruction manual.
- If the product is returned for repair through a dealer not authorised by us.
- If the original receipt of purchase cannot be provided.
- If the defect is as a result of improper use or incorrect maintenance, negligence or impact damage.
- If the parts show normal wear and tear that may be expected from daily use of the product (wheels, rotating or moving parts etc).
- The warranty of this product becomes valid from the date of purchase as stated on the original receipt of purchase. This does not affect your statutory rights.

REGISTER YOUR WARRANTY:

babystyledirect.co.uk/register-product/

We are proudly
part of the



bpia.co.uk

BabyStyle[®]

36 Charles Street, Sileby,
Leicestershire LE12 7RJ.

T: 01509 816444

E: info@babystyle.co.uk

www.babystyle.co.uk

©BabyStyle UK Ltd JG1224010426